

IN CASE OF EMERGENCY
REMOVE PEOPLE IN IMMEDIATE DANGER
ALERT OTHERS
CONFINE FIRE AND SMOKE
EVACUATE TO ASSEMBLY AREA

RING 000

EVACUATION PROCEDURES

EVACUATION PROCEDURE FOR COCKBURN ICE ARENA

IN THE OF AN EMERGENCY AN ALARM WILL SOUND. AN APPROPRIATE / QUALIFIED STAFF MEMBER WILL NOTIFY ALL STAFF AND PUBLIC THE URGENCY OF THE SITUATION AND THE NEED TO EVACUATE. EMERGENCY LIGHTS WILL COME ON IMMEDIATELY AND ALL STAFF WILL BEGIN CHECKING ALL AREAS TO ENSURE THE BUILDING IS EMPTY OF ALL PERSONS.

STAFF WILL INDICATE THE BEST METHOD TO EXIT THE BUILDING, HOWEVER ALL EMERGENCY DOOR EXITS WILL LIGHT UP.

ALL STAFF AND PATRONS WILL BE ASKED TO CONGREGATE AT A SAFE PLACE OUTSIDE THE BUILDING SO ALL PERSONS MAY BE ACCOUNTED FOR.

COMMUNICATION WITH STAFF AND PUBLIC WILL BE MADE VIA TWO METHODS

1. LOUD SPEAKER SYSTEM
2. TELEPHONE SYSTEM

EVACUATION SITE

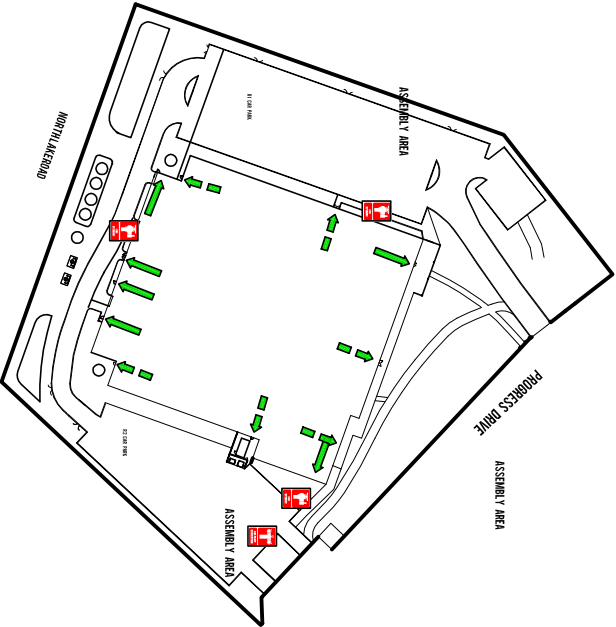

COCKBURN ICE ARENA
401 PROGRESS DRIVE
BIBRALAKE

EVACUATION DIAGRAM

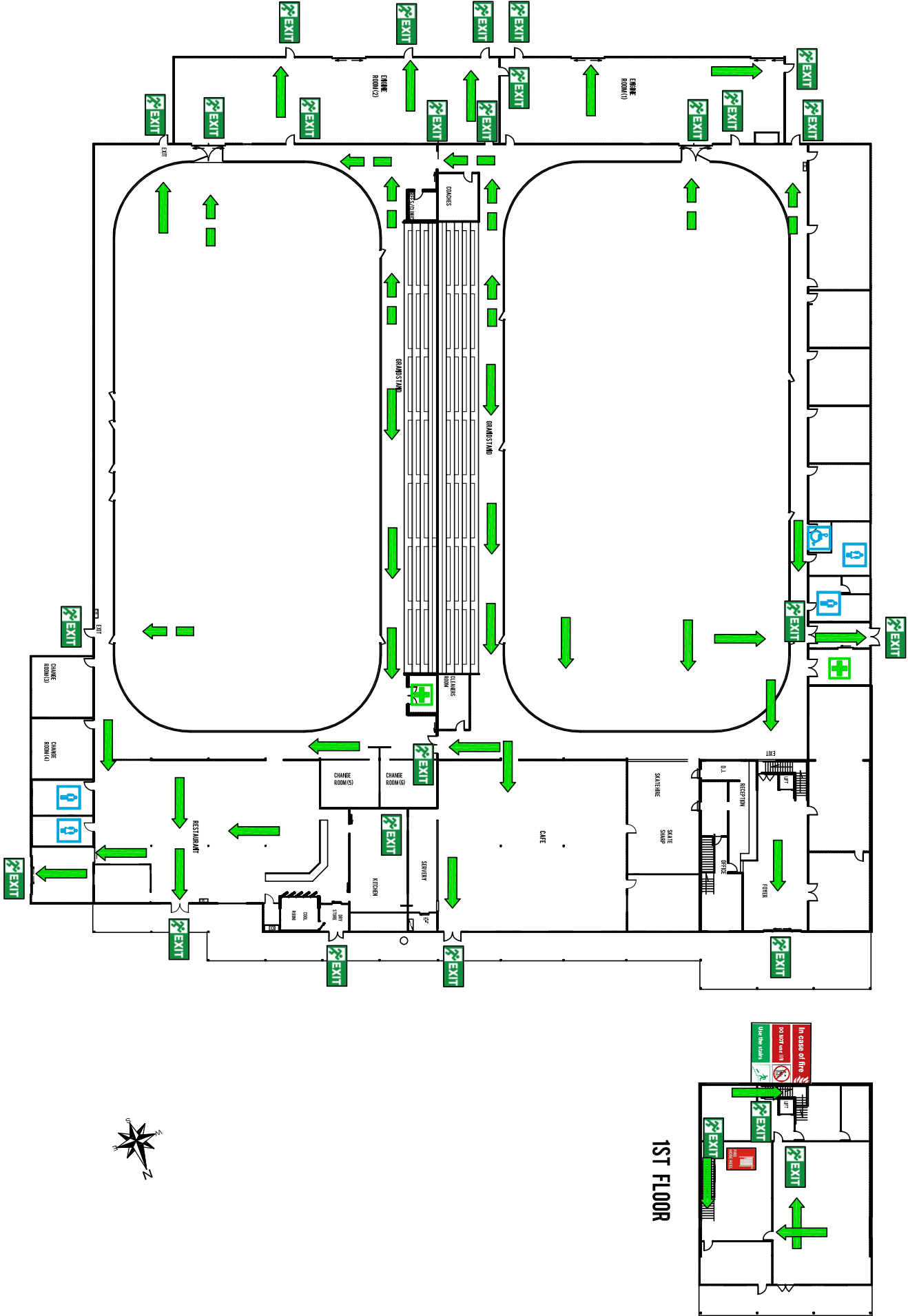

1ST FLOOR



FIRST AID



DISABLED TOILET



MALE TOILET



FEMALE TOILET

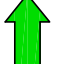

PRIMARY EXIT ROUTE



EMERGENCY EXIT



SECONDARY EXIT ROUTE



In case of fire
DO NOT use lift



Use the stairs



LIFT SIGNAGE

The logo for the Cockburn Ice Arena, featuring a stylized blue and white snowflake design with the text 'cockburn ice arena' in blue and white.